

SET-UP INSTRUCTIONS

Booth Buddy™

FOR BEST PRESENTATION For best results, remove the drape from the pipe at your booth space. If you choose not to remove the drapes, proceed to "for faster set-up." (NOTE: A chair is suggested for installation.)



Remove the 9' w x 8' h fabric backdrop and bungees from the 15" w x 15" h bag. Unfold the backdrop.

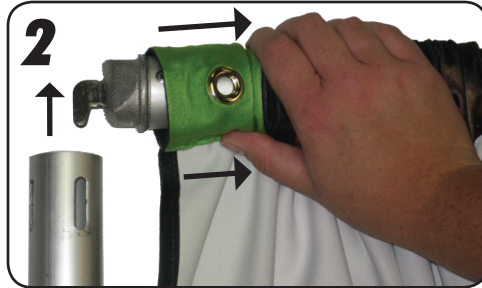

Release the horizontal pole from the vertical poles. Slide the Booth Buddy graphic fabric panel onto the horizontal pole with the grommets facing to the rear.

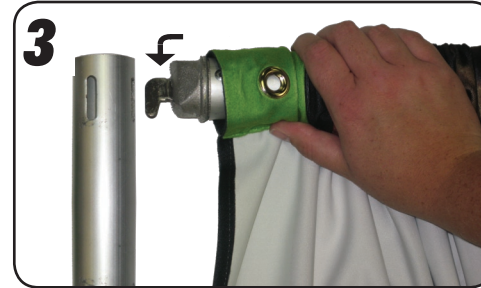

Return the horizontal pole in the slots on the vertical pole, securing the pole into position.

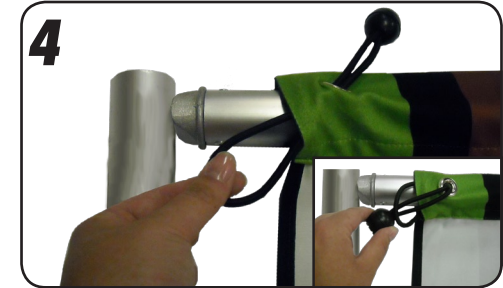

Pull the black bungee cords through the grommets and loop the knob back through the bungee on all four corners.



To add tension and secure the backdrop, hook the bungee over the vertical pole.



On the bottom, wrap the white bungees around the base of the vertical pole.



Wrap the black bungee around the vertical pole below the white bungee to tension the fabric.

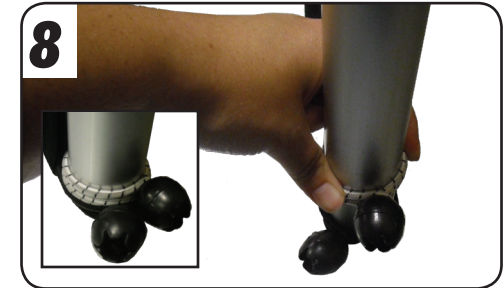

Push down on the white bungee, securing the black bungee between the base of the pole and the stand bottom. Set-up is complete.

FOR FASTER SET-UP With show drapery remaining attached. (NOTE: A chair is suggested for installation.)



Remove the 9' w x 8' h fabric backdrop and bungees from the 15" w x 15" h bag. Unfold the Booth Buddy backdrop.

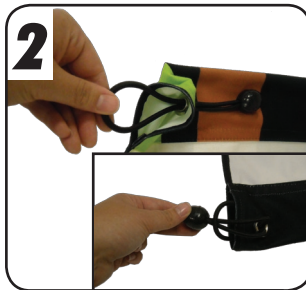

Pull the black bungee cords through the grommets and loop the knob back through the bungee on all four corners.

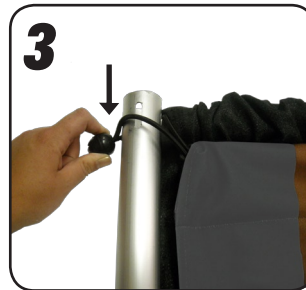

Hang the bungees over the vertical poles on both ends. Make sure your graphic is facing the front of the booth.

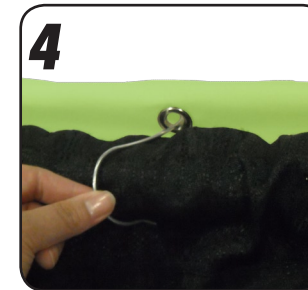

Insert the small end of the S-hook through the grommet hole. Hang the large end over the drape covered pole. Complete this for all "non-bungeed" grommet holes.

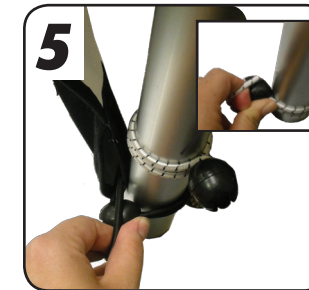

Wrap the white bungee around the base of the vertical pole. Wrap the black bungee around the pole below the white bungee to tension the fabric.



Push down on the white bungee, securing the black bungee between the base of the pole and the stand bottom. Set-up is complete.

SKU: BB.SETUP
VERSION 07.09

LAARHOVEN DESIGN
EXHIBITS THAT ENGAGE